

Phalon[®]
PERTAMA DAN TERBAIK



pipa uPVC & fittings

(SNI No. 06-0084-2002 & SNI No. 06-0162-1987)



Download from mepbali.net

"BELL END" (RUBBER RING JOINT)

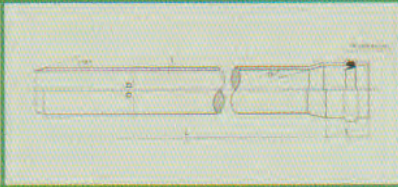

Satuan :mm.

UKURAN NOMINAL	NOMINAL OD	SNI 06-0084-2002/ISO 4065-1978					SNI 06-0162-1987		PANJANG STANDARD	
		S-6,3	S-8	S-10	S-12,5	S-16	Kelas A	Kelas B	E	L
50(2")	63	4.7	3.8	3.0	2.4	2.0	1.8	3.2	115	6000 ± 5
65(2½")	75	5.5	4.5	3.6	2.9	2.3	1.8	3.2	115	6000 ± 5
75(3")	90	6.6	5.4	4.3	3.5	2.8	1.8	3.2	125	6000 ± 5
100(4")	110	8.2	6.6	5.3	4.2	3.4	2.2	3.2	130	6000 ± 5
125(5")	140	10.3	8.3	6.7	5.4	4.3	-	-	145	6000 ± 5
150(6")	160	11.8	9.5	7.7	6.2	4.9	3.2	4.0	160	6000 ± 5
200(8")	200	14.7	11.9	9.6	7.7	6.2	3.9	4.9	175	6000 ± 5
200(8")	225	16.6	13.4	10.8	8.6	6.9	-	-	180	6000 ± 5
250(10")	250	18.4	14.8	11.9	9.9	7.7	4.9	6.2	195	6000 ± 5
250(10")	280	20.6	16.6	13.4	10.7	8.6	-	-	200	6000 ± 5
300(12")	315	23.2	18.7	15.0	12.1	9.7	6.2	7.7	215	6000 ± 5
350(14")	355	26.1	21.1	16.9	13.6	10.9	-	-	260	6000 ± 5
400(16")	400	29.4	23.7	19.1	15.3	12.3	7.8	9.8	290	6000 ± 5
450(18")	450	-	26.7	21.5	17.2	13.8	-	-	320	6000 ± 5
500(20")	500	-	29.6	23.9	19.1	15.3	9.8	12.3	340	6000 ± 5
600(24")	630	-	-	30.0	24.1	19.3	12.3	15.4	415	6000 ± 5

"TS END" (SOLVENT CEMENT JOINT)

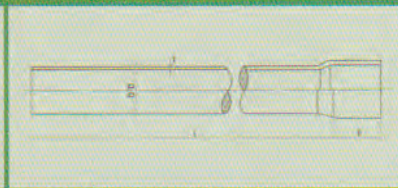
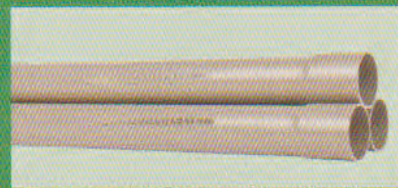

Satuan :mm.

UKURAN NOMINAL	NOMINAL OD	SNI 06-0084-2002/ISO 4065-1978					SNI 06-0162-1987		PANJANG STANDARD	
		S-6,3	S-8	S-10	S-12,5	S-16	Kelas A	Kelas B	E	L
15(½")	20	1.5	-	-	-	-	-	-	37	6000 ± 5
20(¾")	25	1.9	1.5	-	-	-	-	-	40	6000 ± 5
25(1")	32	2.4	1.9	1.6	-	-	-	-	44	6000 ± 5
30(1¼")	40	3.0	2.4	1.9	1.6	1.5	1.8	3.2	49	6000 ± 5
40(1½")	50	3.7	3.0	2.4	2.0	1.6	1.8	3.2	55	6000 ± 5
50(2")	63	4.7	3.8	3.0	2.4	2.0	1.8	3.2	63	6000 ± 5
65(2½")	75	5.5	4.5	3.6	2.9	2.3	1.8	3.2	70	6000 ± 5
75(3")	90	6.6	5.4	4.3	3.5	2.8	1.8	3.2	79	6000 ± 5
100(4")	110	8.2	6.6	5.3	4.2	3.4	2.2	3.2	91	6000 ± 5
125(5")	140	10.3	8.3	6.7	5.4	4.3	-	-	109	6000 ± 5
150(6")	160	11.8	9.5	7.7	6.2	4.9	3.2	4.0	121	6000 ± 5
200(8")	200	14.7	11.9	9.6	7.7	6.2	3.9	4.9	145	6000 ± 5
200(8")	225	16.6	13.4	10.8	8.6	6.9	-	-	160	6000 ± 5
250(10")	250	18.4	14.8	11.9	9.9	7.7	4.9	6.2	175	6000 ± 5
250(10")	280	20.6	16.6	13.4	10.7	8.6	-	-	196	6000 ± 5
300(12")	315	23.2	18.7	15.0	12.1	9.7	6.2	7.7	214	6000 ± 5
350(14")	355	26.1	21.1	16.9	13.6	10.9	-	-	238	6000 ± 5
400(16")	400	29.4	23.7	19.1	15.3	12.3	7.8	9.8	265	6000 ± 5

Metode Penyambungan

Rubber Ring Jointing System

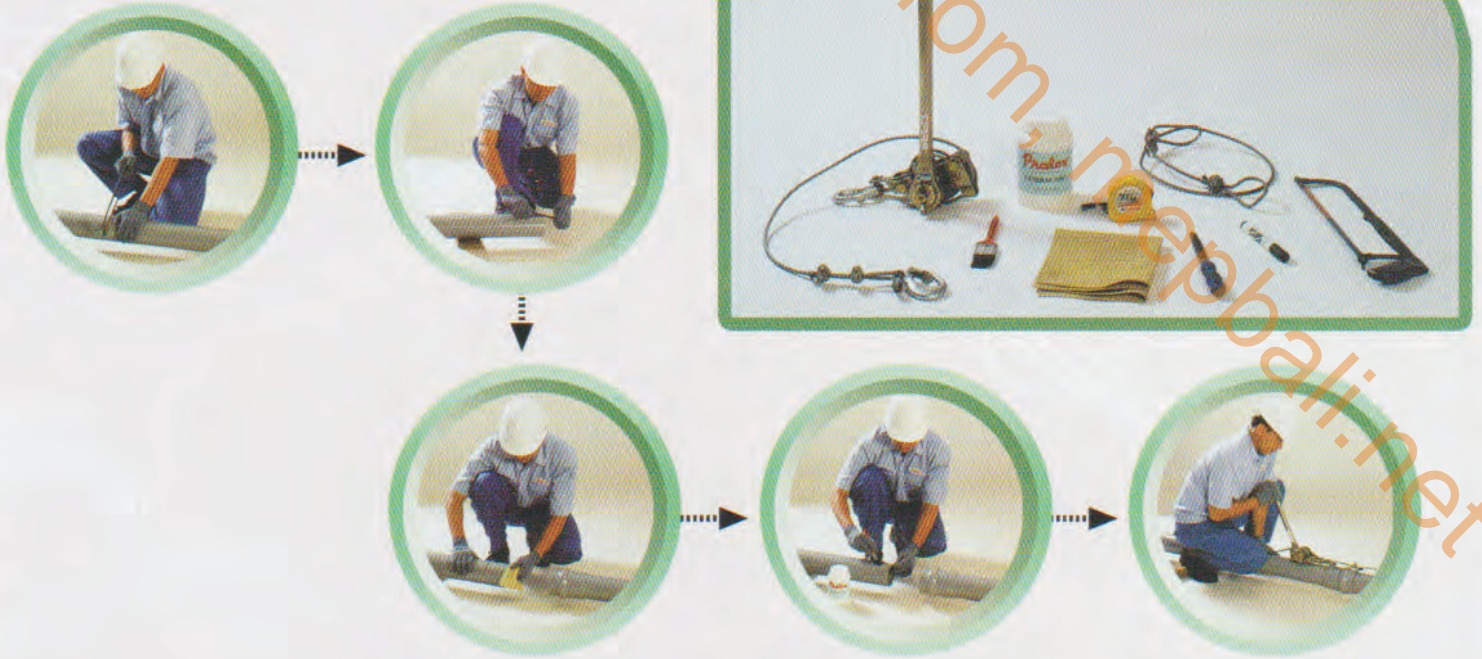

Solvent Cement Jointing System



Bell Fittings



Flange Bell End



Flange Spigot



Dresser Joint



Bell Spigot



Bell Repair Socket



Bell Socket



Bell VA/VC Socket



Bell Long TY Bell Branch



Bell Y Bell Branch



Bell Tee Bell Branch



All Bell Tee

Bell Bend

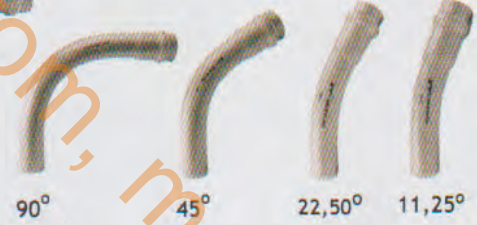

90° 45° 22,50° 11,25°



Bell Reducer



Bell S Bend



Bell Tee TS Branch

TS Fittings



Clamp Saddle



Flange Socket



TS. Elbow



TS. Cap



90° 45° 22,50° 11,25°

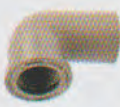

TS. Faucet Elbow



TS. Tee



TS. Faucet Tee



Reducer Socket



Slow Dry



Quick Dry



TS. Faucet Socket



Socket



TS. Valve Socket



VA/VC Socket



Quick Dry



Distribusi oleh :



PT. GOLDEN PIPING INDONESIA
 Jl. Pahlawan Seribu, Ruko Golden Boulevard Blok E-30 BSD City
 Kota Tangerang Selatan 15320 Banten Indonesia
 Telp.: +62 21 5315 6333, 5315 9333 Fax.: +62 21 5316 7333
 Email : info@depopipa.com