





# FD series

High Performance Packaged Air-Conditioners

2025



**RC-ES1** **New M-Air Pro**

Design Remote Control Mobile App

MOVE THE WORLD FORWARD  MITSUBISHI  
HEAVY  
INDUSTRIES  
GROUP

# High Performance Air-Conditioning FD series

The PAC range from Mitsubishi Heavy Industries Thermal system is ideal for air conditioning offices, shops, restaurants, and bar as well as other commercial environments. The versatility of the PAC range offers you a wide selection of models in function of your installation needs. The modern and attractive design of our indoor units is harmoniously integrated in the any atmosphere creating a pleasant and relaxing environment.



# CONTENTS

Next Generation Refrigerant R32	4
New generation FDT	5
Draft Prevention	6
Motion sensor	7
Remote control	8
Product Line-up	12
Indoor units Benefits summary	13

## Inverter Series

FDT Ceiling Cassette	15
FDUM&FDU Duct Connected	17
FDE Ceiling Suspended	19
SRK Wall Mounted	21

## Non-Inverter Series

FDT Ceiling Cassette	22
FDUM Duct Connected	24
FDE Ceiling Suspended	26
FDF Floor Standing	28

## Big capacity Series

FDU Duct Connected	29
FDF Floor Standing	30
Usage Limitation	31



# Next Generation Refrigerant R32

All indoor units and outdoor units line up are available for R32 refrigerant



- A Low GWP Refrigerant
- A single component, easy to handle refrigerant
- Known as a component of the blend R410A(50% R32, 50% R125)
- Already used in Air Conditioning systems worldwide
- Zero Ozone Depletion
- Superior Energy Efficiency vs. R410A
- Reduced refrigerant charge vs. R410A
- Easy to recycle

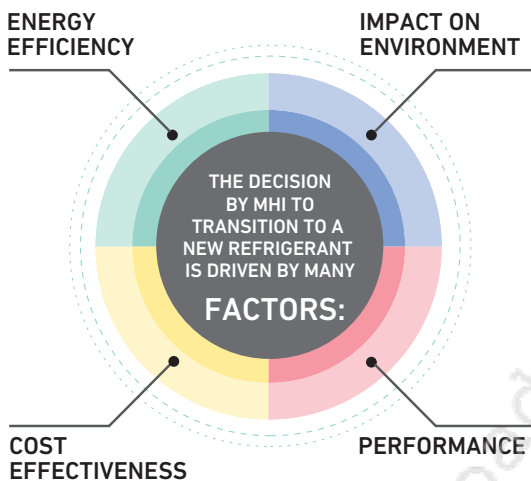

## Low Global Warming Potential

1/3 GWP VS. R410A

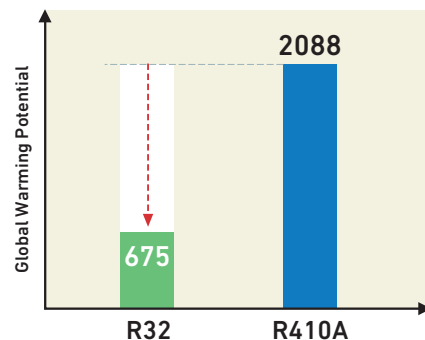

GWP Values based on IPCC 4th Assessment Report

## Superior Energy Efficiency

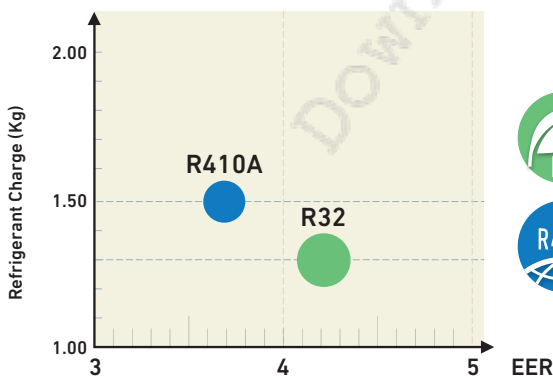

FDT



FDU



FDUM



FDE

## Reduced Refrigerant Charge

Saving up to 20%

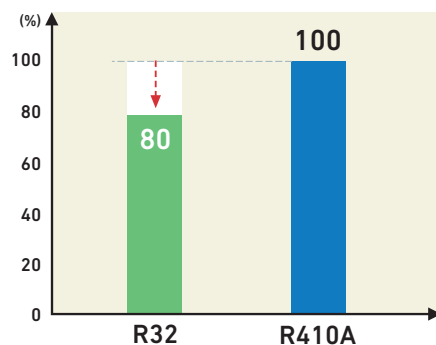

Energy Efficiency Ratio Based on 6.0 kW Ceiling cassette 4way unit

# New Generation FDT

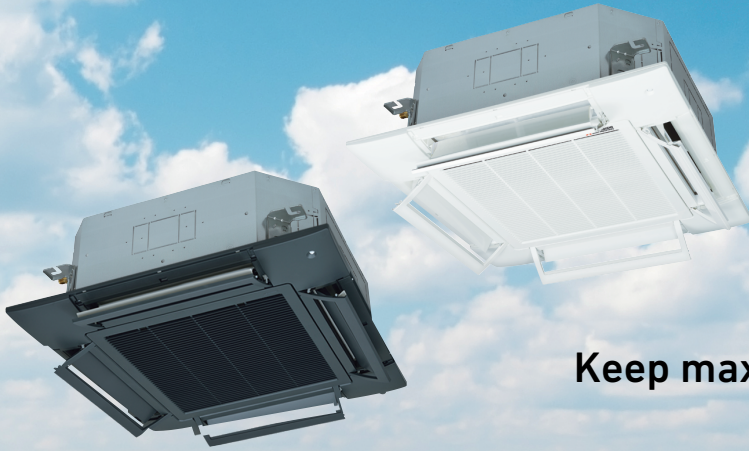

Automatic energy saving control

Keep maximum comfort with minimal draft

Quiet operation

## High energy efficiency with new technology

New FDT can achieve higher Coefficient of Performance (COP) by Mitsubishi Heavy Industries latest technology.

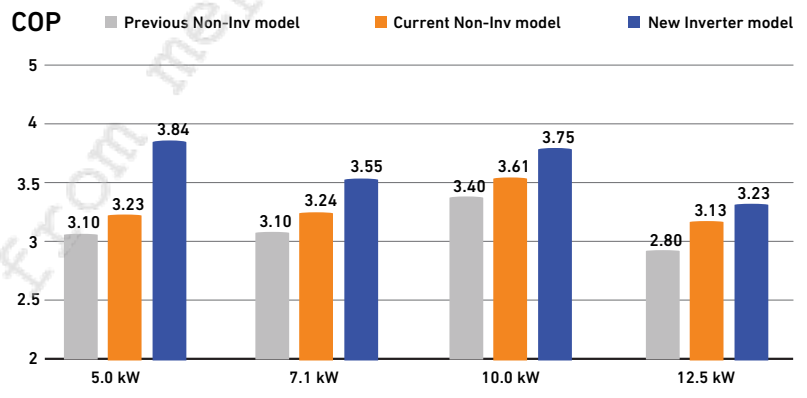

## Quieter noise & Improved aerodynamic performance of the unit

New technology achieved low noise while keeping capacity and comfort by reducing the pressure fluctuation in an indoor unit. A fan guard ensures both safety and quietness.



Turbo fan



Fan guard (standard equipment)

## New Various panels available

You can choose white and black panel according to the atmosphere and purpose of the room.



White panel (Fine snow)



Black panel (Shadow black)

## Flexible flap control for draft prevention. Brand new function in the market



### Draft Prevention Panel (Option)

4 additional flaps are to be controlled individually at each operation mode. They change air flow direction and prevents draft feeling. This new function also achieve more flexible control for air flow direction



### Motion Sensor (Option)

New motion sensor (option) detects human activity. Energy saving control is achieved by shifting set temperature according to detected amount of activity.

# Draft Prevention

Keep maximum comfort with minimal draft:  
New FDT & FDTC control flaps with more flexibility.

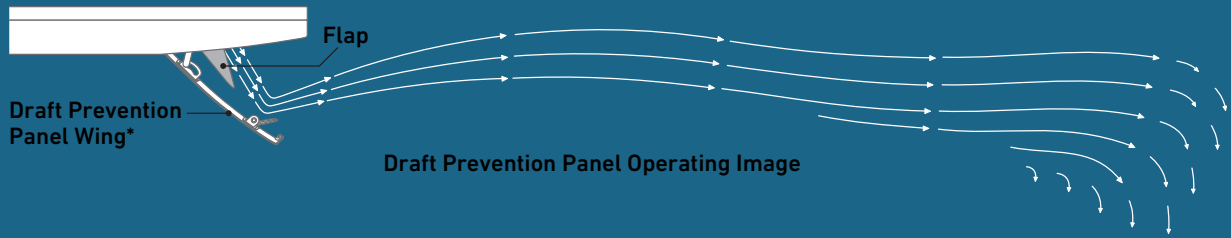

Draft Prevention Panel off

Draft Prevention Panel working \*

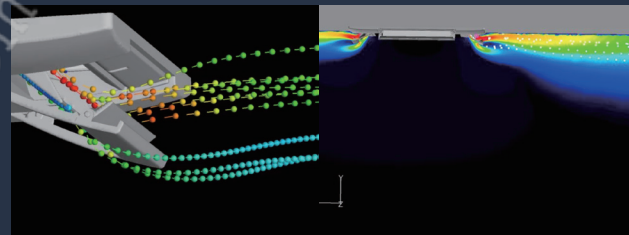
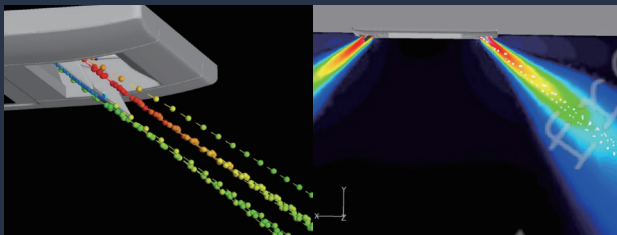

Draft Prevention Panel provides a comfortable airflow without any draft feeling. Whether cooling or heating a room, the remote control can be used to instantly suppress any warm or cool drafts. This accurately assists how air flow is directed out of the indoor unit.

\* Images is for illustration purposes.



Ceiling cassette  
**FDT** series

Keep maximum comfort  
with minimal draft :  
New FDT control  
flaps with more flexibility

# Motion sensor

Energy saving operation  
by detecting human movement



## 3 Step Control

- 1 Power Control** New motion sensor (option) detects human activity. Energy saving control is achieved by shifting set temperature according to detected amount of activity.
- 2 Stand by** Unit will go on stand-by mode when no activity is detected. When the motion sensor detects activity again, the unit will automatically re-start operation.
- 3 Auto Off** Unit will go off automatically when no activity is detected for 12 hours.

Optional for models



FDT



FDU



FDUM



FDE

Low human activity (in cooling)



High human activity (in cooling)



Absence for 1 hour



12 hours absence

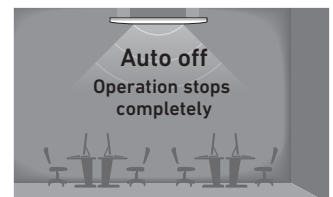

in cooling  
Set temperature  
**26°C**

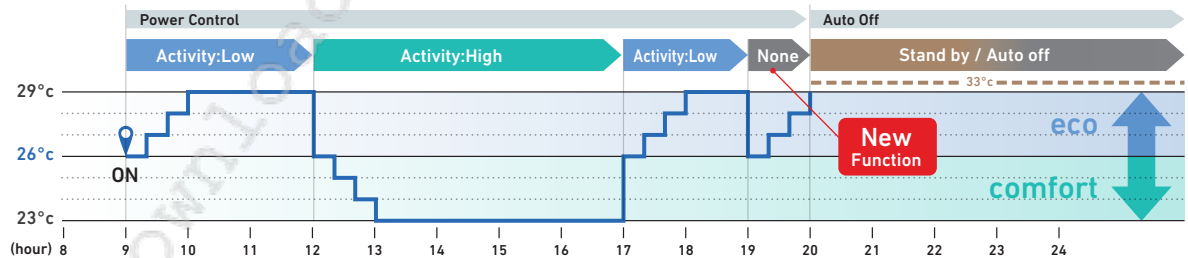

Operation mode and  
Control of Motion sensor

eco operation  
comfort operation

Operation mode

		Operation mode			
		Auto	Cool	Dry	Fan
Power Control *1	Human activity				
	Low	Cooling +3°C	+3°C	—	—
	High	Cooling -3°C	-3°C	—	—
	None	Cooling +3°C	+3°C	—	—
Auto Off *2		●	●	●	●

\*1 Set temperature is revised maximum  $\pm 3^{\circ}\text{C}$  at Cooling

\*2 Absence for 1 hour  $\Rightarrow$  Operation stops ("Stand-by") 12 hours absence  $\Rightarrow$  Operation stops completely

# New! Design Remote Control

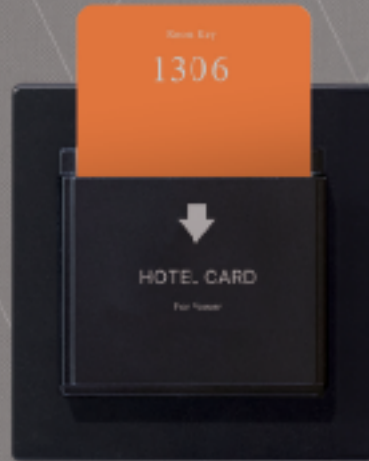

## RC-ES1

- Simple and sophisticated design
- Compact size (86×86mm)
- Remote control with Bluetooth® wireless technology

- Simple and sophisticated design
- Compact size (86×86mm)
- Remote control with Bluetooth® wireless technology

You can control the air-conditioner by installing App on your Smartphone



Search for "M-Air Pro" from the GooglePlay™ store for Android™ and AppStore for iPhone.



Application compatible model: Android™ OS 9.0 or later smartphones and tablets, iPhone for iOS 14.0 or later. App Store and iPhone are registered trademarks of Apple Inc. Google Play and the Google Play logo are trademarks of Google LLC.

### Wireless connection

- Remote control with Bluetooth® wireless technology
- Easy set-up of indoor units
- Notifications of abnormal conditions or operational data from the remote control will be sent to your smartphone.

### Information screen

By looking at the information screen, you can check the current operating conditions at a glance.

### Central management by smart phone

You can select and change the settings of multiple rooms with only one action on your smartphone.\*

### Easy installation with the new casing structure

The casing is separated into the lower and the upper case. By inserting the upper case into the lower case embedded to the wall, the remote could be easily installed.

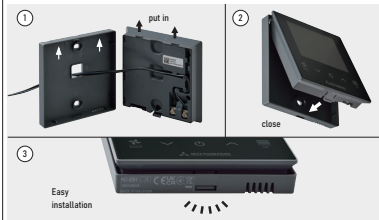
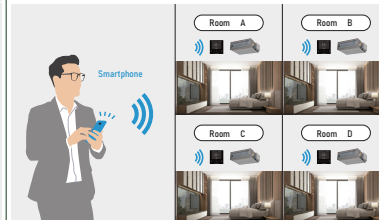

\*The function would be available when the smartphone is connected to the remote control with Bluetooth® wireless technology.

### Easy to instinctively operate with simplified icons

#### Operation settings

	Operation mode	Heating / Cooling / Fan / Dry / Auto
	High power	ON / OFF
	Ventilation	ON / OFF
	Timer	Set ON / OFF timer by hour Set ON / OFF timer by clock
	Air direction	Upper / lower flap, Flap direction

#### Common settings

	Bluetooth	ON / OFF
	Pairing mode	Make a new Bluetooth pairing
	App QR code	QR code for the app

#### Display & sound settings

	Brightness	1-10
	Lighting time	1-10
	Operation sound	Sound On / Sound Off

### Information screen

	Temporary stop		High power operation		Motion sensor control		On timer setting
	Thermo-off		Eco operation		Anti draft control		OFF timer setting
	Fan operation		Set temp. shift		Demand control		Weekly timer setting
	Cooling test run		Warm up operation		Filter cleaning time		Sleep timer setting
	Static pressure adjustment		Heating preparation		Back-up control in operation		
	Dew drop prevention control		Defrost operation		Fault back-up control in operation		
	Home leave operation		Outdoor silent operation		Periodical check indication		

\*The Bluetooth® word mark and logos are registered trademarks owned by Bluetooth SIG, Inc. and any use of such marks by MITSUBISHI HEAVY INDUSTRIES THERMAL SYSTEMS, LTD. is under license. Other trademarks and trade names are those of their respective owners. \*QR Code is a registered trademark of DENSO WAVE INCORPORATED.

# Remote Control

Simple use with advanced settings  
REMOTE CONTROL

Intuitive touch controller with  
Liquid Crystal Display



# RC-EX3A

## Function Switch

The function switch allows the user to select preferred two functions that are desired from the seven available functions shown. These functions can be used by simply pressing the button after they are set, allowing you to use your preferable functions immediately.

### 1. Draft prevention ON/OFF

Anti draft can be turned ON/OFF with a single tap of the button.

### 5. Home Leave Mode

Home leave mode maintains the room temperature at a moderate level.

### 2. High Power Mode

High Power Mode achieve excessive cooling capacity in 15 minutes to quickly adjust the room temperature to a comfortable level.

### 6. Favourite Mode

Operation mode, set temperature, fan speed and air flow direction will automatically be adjusted to the programmed favorite setting.

### 3. Energy Saving Mode

Temperature is set to be optimized to save energy without losing comfort.

### 7. Filter Sign

Announces the due time for cleaning the air filter.

### 4. Quiet Mode

Outdoor unit starts to operate quietly by activating this mode. The time of this mode can be set in conjunction with Indoor Silent Timer.

## Favourite Mode

Operation mode, set temperature, fan speed and air flow direction are memorized and allocated to two buttons that can be operated by one touch.

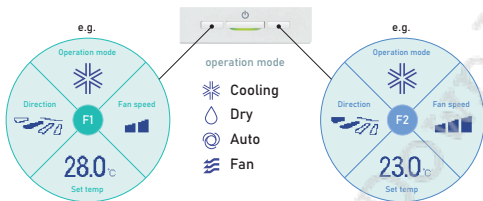

## Adjustable Brightness of the Operation Lamp

The brightness of the operation lamp behind Run/Stop switch can be adjusted by 10 stages.



## Draft Prevention Setting

(only FDT•FDTC series)

User can enable/disable the motion of Draft prevention panel for each air outlet for each operation mode. This function can be set while operating.

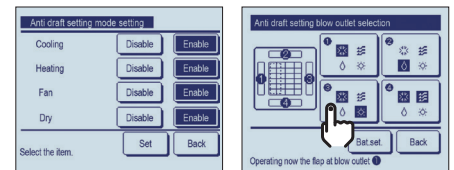

## Easy Adjustment of the Air Flow

User can visually confirm and set the direction of flaps using the visual display on the remote controller.

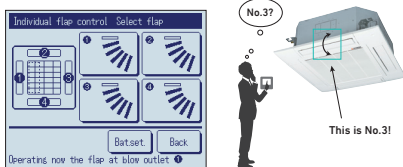

## Motion Sensor Control

Presence of humans and activity are detected by a motion sensor to perform various controls.

### 1 Select Enable / Disable Motion sensor control



Enable/Disable

### 2 Select Enable / Disable per control

- Power control
- Auto-off

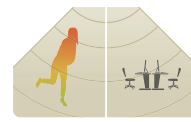

Enable/Disable

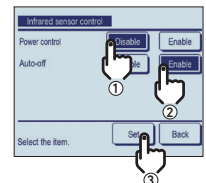

# Backup Control

Control restricted to two indoor units (two groups)



## Fault backup control

**Reassurance** **Comfort**

### Keep back up all the time!

If one of the two indoor units malfunctions and stops its operation, the other starts backup operation so that users' comfort will not be compromised.

## Capacity backup control

**Comfort** **Energy saving** **Longer unit life**

### Maintains users' comfort!

When the control system detects either of its two units operating with overload, the other unit cover the capacity.

## Rotational operation control

**Longer unit life** **Energy saving**

### Energy saving and longer life!

By operating two indoor units alternately, their chronological changes are equalized. (The alternate operation cycle can be specified in a range from 1 to 999 hours in increments of 1 hours.)

## Additional Functions of External Input / Output

The external input/output of indoor unit by remote controller can set input/output based on user's demand.

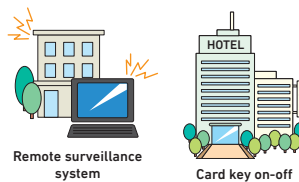

### External Input

CNT (1-6)	CNTA (1-2)
Input	On/Off Permission/Prohibition Cooling/Heating Emergency Stop
	<b>Newly added</b> Set temp. shift Forced thermo-off IU operation stop Silent mode

### External Output

CNT (New)	Output
2	- Operation - Heating - Compressor ON (thermo-ON)
3	- Inspection <b>Cooling (defrosting)</b> Fan operation
4	- Fan operation with Phi or Hi - Fan operation with Me or Lo - Defrosting (oil return in heating operation) - Ventilation
5	Heater ON Free cooling IU overload alarm

**Newly added**

## Silent Mode Control

The Outdoor unit is controlled prioritising quiet operation. Silent mode control must be set to the F1 or F2 switch. User can start/stop the silent mode control with a single tap of a button.

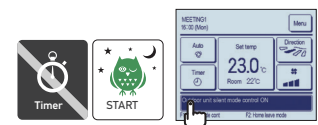

## Language Switching

User can select from the following languages and also switch them on the top display.

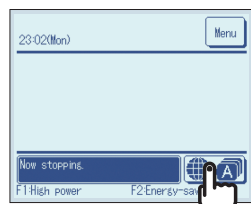

## Indoor Unit Capacity Display

Capacities of Indoor units connected to the RC-EX3A are displayed.

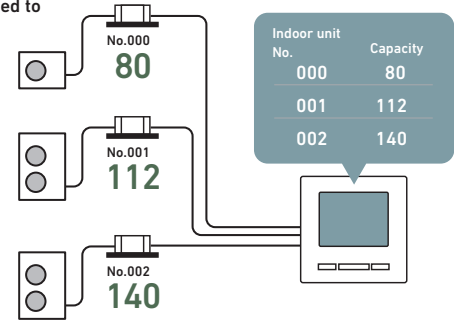
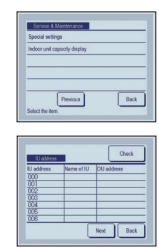

# Error display

If any error occurs on the air conditioner, the "Unit protection stop" is indicated on the message display.



**"Error"**

# SUPERLINK II Control Systems

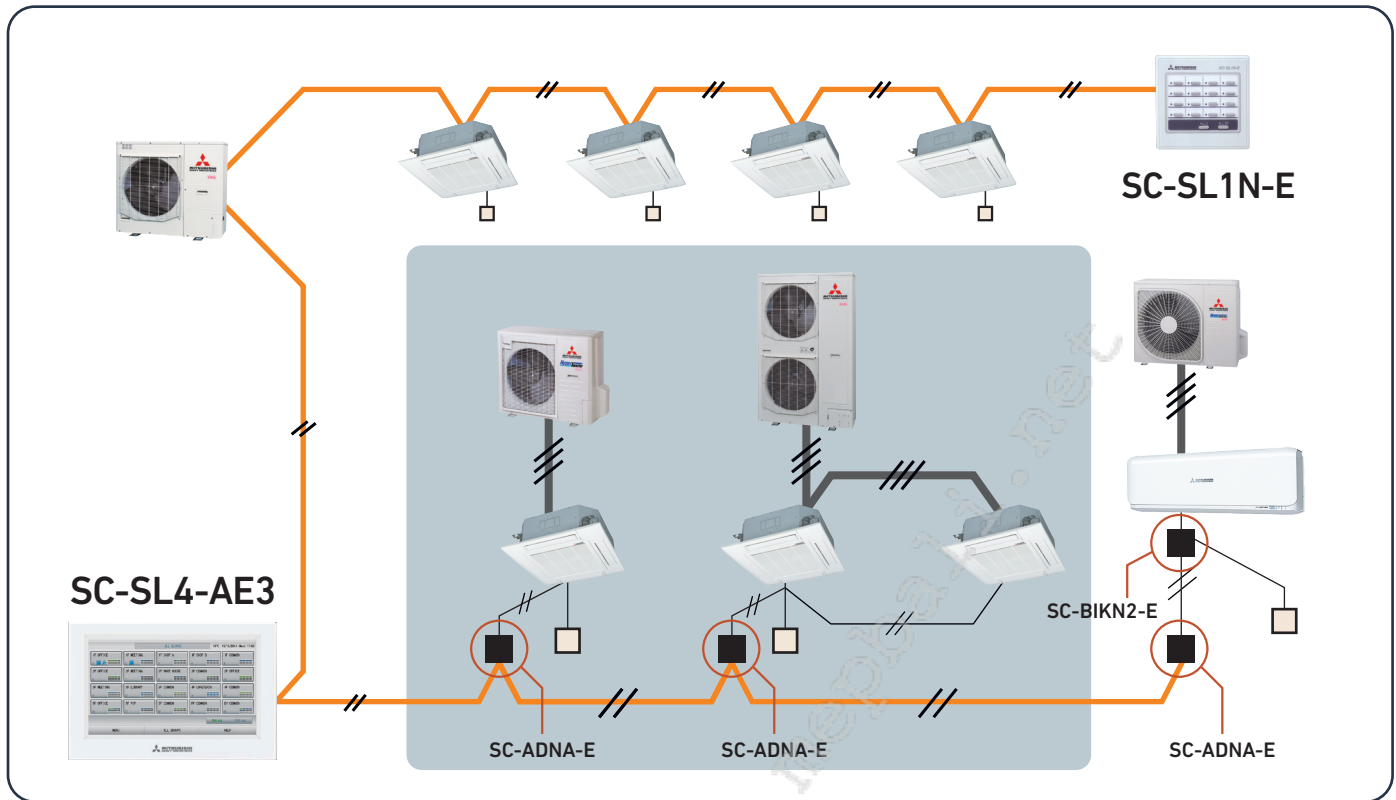

## Central Control



### SC-SL1N-E

Start/stop control of up to 16 indoor units is possible either individually or collectively. With simple operations, you can achieve centralized control.

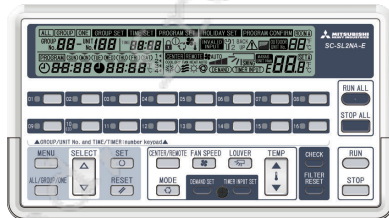

### SC-SL2NA-E

Centralized control of up to 64 indoor units. Including weekly timer function as standard.

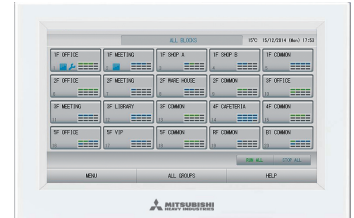

New

### SC-SL4-AE3/BE3

Easy operation thanks to with a large colour LCD and touch panel. Up to 128 indoor units can be controlled, when SUPERLINK-II systems are connected.

## Building Management Systems

## Production by order



### SC-WBGW256\*

Web gateway  
BACnet gateway

SC-WBGW256, up to 256 cells (some cells can have two or more indoor units and total number of indoor units can be up to 256 units) are controlled from the Internet Explorer and centrally from Building Management Systems.

Users can manage up to 1024 units by connecting the four devices !!



### SC-LGWNB\*

LonWorks gateway

Up to 96 indoor units can be integrated to a central control point via the building management system network.

\* Additional engineering service is required. Please consult your dealer when using these system.



# Indoor units BENEFITS SUMMARY

FDT	FDU	FDUM	FDE	SRK	FDT	FDUM	FDE	FDI
INVERTER					NON-INVERTER			

<b>Energy-Saving</b> 	<b>Inverter Technology</b> Inverter control technology delivers high efficiency and a smooth operation from high speed to low speed. A smooth sine voltage wave is attained.	●	●	●	●	●			
	<b>Energy-Saving Operation *</b> Since the capacity is controlled automatically based on the outdoor temperature, energy can be saved without losing comfort.	●	●	●	●	●			
	<b>Motion Sensor *</b> This sensor detects human activity and shifts the temperature setting according to the amount of activity in the room.	Option	Option	Option	Option	Option	Option		
	<b>Home Leave Operation</b> This function ensures that when the room is unoccupied for long periods of time, the unit will maintain a moderate indoor temperature, avoiding extremely hot or cool temperatures.	●	●	●	●	●			
	<b>Set Temperature Auto Return *</b> This function allows the user to program a preferred set temperature that the unit will return to each time it is operated.	●	●	●	●	●	●	●	●
<b>Comfort</b> 	<b>Automatic Operation</b> This function automatically selects the required heating or cooling function based on the current room conditions.	●	●	●	●	●	●	●	●
	<b>Silent Operation</b> This function allows the user to program periods where the unit will operate with reduced noise levels, perfect for night time and an uninterrupted sleep.	●	●	●	●	●			
	<b>Hi Power Operation</b> Use the high power function to quickly reach your optimum temperature level when you first turn on the unit. This function will operate for a maximum of 15 minutes before returning to normal operation.	●	●	●	●	●			
<b>Air Flow</b> 	<b>Flap Control System</b> This function allows the user to set the upper and lower limit positions of the flap at each air outlet individually, providing you with complete control over interior air flow.	●			●	●	●		●
	<b>Vertical Auto Swing</b> The vertical louvers on your unit will move up and down continuously during operation. This function allows you to set the up/down swing position of the louver to the preferred operation angle.	●			●	●	●		●
	<b>Draft Prevention Setting *</b> Draft Prevention setting provides a comfortable air flow without any draft feeling. Whether cooling or heating a room, the remote control can be used to instantly suppress any warm or cool drafts. This accurately assists how air flow is directed out of the indoor unit.	Option					Option		
	<b>Automatic Fan Speed</b> The unit's on-board microcomputer continuously monitors the room's air temperature and adjusts the air flow automatically.	●	●	●	●	●	●	●	●

FDT FDU FDUM FDE SRK FDT FDUM FDE FDF

INVERTER NON-INVERTER



		FDT	FDU	FDUM	FDE	SRK	FDT	FDUM	FDE	FDF
		INVERTER					NON-INVERTER			
<b>Timer</b> 	<b>Sleep Timer</b> This function allows the user to set a pre-determined amount of time between 30 and 240 minutes that your unit will operate for before switching off.	●	●	●	●	●	●	●	●	
	<b>Peak-Cut Timer *</b> This function lets the user to preset the capacity limit during certain periods of the day, minimising energy consumption during peak billing times, thus reducing operation costs.	●	●	●	●	●				
	<b>Weekly Timer</b> Set the unit to turn on and off automatically on a weekly basis to suit your usual room usage on each day.	●	●	●	●	●	●	●	●	
<b>Convenience</b> 	<b>Function Switch *</b> From the seven available functions on the unit, this function allows the user to set two functions to operate automatically.	●	●	●	●	●	●	●	●	
	<b>Favourite Setting *</b> Operation mode, set temperature, fan speed and air flow direction automatically adjust to the programmed favourite setting.	●	●	●	●	●	●	●	●	
	<b>Select the Language *</b> Set the language to be displayed on the remote control.	●	●	●	●	●	●	●	●	
	<b>Air Filter</b> The air filter in the unit traps and removes airborne dust particles and other allergens to provide you clean air.	●	Procure locally	● Option	●	●	●	●	● Option	●
	<b>Filter Sign</b> This warning alerts when the filter needs to be cleaned.	●	●	●	●	●	●	●	●	●
	<b>Outside Air Intake</b> This function provides clean fresh air into the room through the external air intake, avoiding the constant recycling of internal air.	●	●	●				●	●	
<b>Others</b>	<b>Self Diagnostics</b> The internal microcomputer automatically runs a diagnostic of the system in the event of a malfunction. This enables authorised dealers to isolate and repair any issues.	●	●	●	●	●	●	●	●	●
	<b>Built in Drain Pump</b> The built-in drain pump, allows greater flexibility with installation, offering a great solution for applications with limited space.	●	●	●				●	●	
	<b>Improved Serviceability</b> The fan unit (comprised of impeller and motor) is easily accessible from either the side or bottom of the unit and can be slid out for easy maintenance.		●	●					●	

When using RC-EX3A (Remote control), functions with symbol ●●●●● are available.

However, for RC-E5 (Remote control), functions with \* are not available.



# CEILING CASSETTE FDT

## Draft Prevention Panel (Option)

Draft Prevention Panel prevents cold draft blown directly on the user. It is possible to set Draft Prevention Panel for each air outlet.



User can position panels by using the remote controller only (RC-EX3A, Wireless kit) when Draft Prevention Panel is available.

## Motion Sensor (Option)

Motion sensor is equipped in the panel corner and detects the presence/absence and activity of humans in a room to improve the comfort and energy saving performance of the unit.



LB-T-5BW-E(White)  
LB-T-5BB-E(Black)

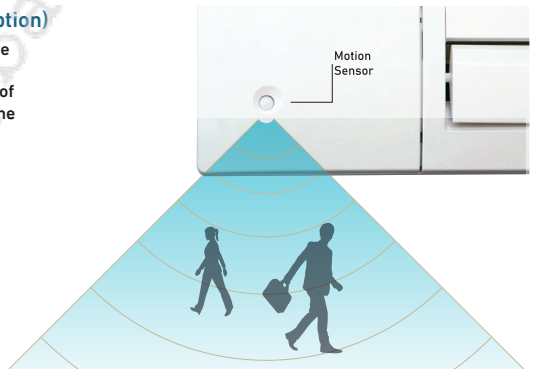

## Individual Flap Control System

According to room conditions, four directions of air flow can be controlled individually by utilizing the flap control is available even after installation.

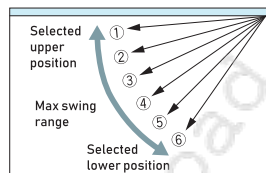

Flap can swing within an upper and lower flap range position within can be selected with a wired remote control.

• The wireless remote control is not applicable to the Individual flap control system.

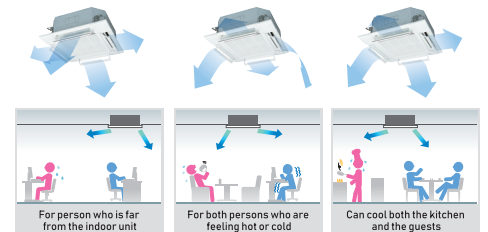

## Panel Select Pattern (Option)

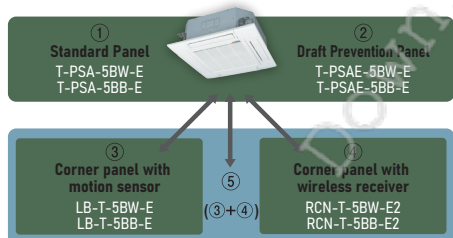

Installation position of Wireless kit and Motion sensor kit

8 patterns of panel are available.

- ① Standard Panel only
- ①+③ Standard Panel with corner panel with motion sensor
- ①+④ Standard Panel with corner panel with wireless receiver
- ①+⑤ Standard Panel with corner panel with motion sensor & corner panel with wireless receiver
- ② Draft Prevention Panel only
- ②+③ Draft Prevention Panel with corner panel with motion sensor
- ②+④ Draft Prevention Panel with corner panel with wireless receiver
- ②+⑤ Draft Prevention Panel with corner panel with motion sensor & corner panel with wireless receiver

## Suitable for High ceilings

The Powerful blowout carries comfortable air flow to the floor even in high ceiling applications. It is ideal for high ceiling offices, stores, etc., with a wide, uniform air flow throughout the room.

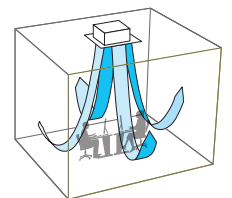

## 850mm Drain Pump

Drain can be discharged upwards up to 850mm from the ceiling surface, allowing a piping layout with a high degree of freedom. Thanks to the 185mm flexible hose, equipment supports easy workability.

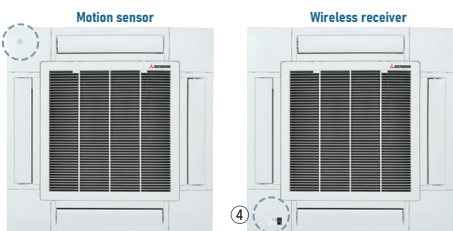
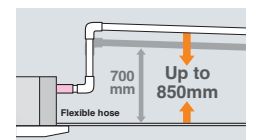

\*Wireless receiver and Motion sensor can be installed to the position as shown

\*Wireless receiver and Motion sensor can be installed to the position as shown

# FDT INVERTER CEILING CASSETTE

FDT40/50/60/71/100/125/140YA-W



Draft Prevention Panel (Option)



FDC40YNA-W  
FDC50YNA-W  
FDC60YNA-W



FDC100YNA-W



FDC71YNA-W



FDC125YNA-W  
FDC140YNA-W

Remote control (option)

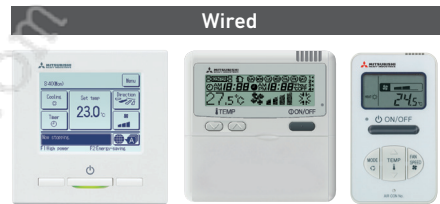

RC-EX3A

RC-E5

RCH-E3



RCN-T-5BW-E2(White)

RCN-T-5BB-E2(Black)

## SPECIFICATIONS

Indoor unit		FDT40YA-W	FDT50YA-W	FDT60YA-W	FDT71YA-W	FDT100YA-W	FDT125YA-W	FDT140YA-W		
Outdoor Unit		FDC40YNA-W	FDC50YNA-W	FDC60YNA-W	FDC71YNA-W	FDC100YNA-W	FDC125YNA-W	FDC140YNA-W		
Power source		1Phase 220-240V, 50Hz/ 220, 60Hz								
Normal cooling capacity (Min-Max)		kW	4.30 (1.6~4.8)	5.30 (1.6~5.7)	6.10 (1.6~6.5)	7.10 (1.3~7.7)	10.5 (2.0~11.5)	12.5 (3.1~12.8)	14.0 (3.2~14.5)	
Power consumption		kW	0.99	1.38	1.72	2.00	2.80	3.87	4.40	
COP		W/W	4.34	3.84	3.55	3.55	3.75	3.23	3.18	
Max.current		A	13	13	13	13.8	17	18.0	24	
Sound pressure level	Indoor (P-Hi/Hi/Me/Lo)	dB(A)	37/33/30/26	41/33/30/26	45/34/30/27	46/34/32/27	47/39/36/30	48/39/37/30	49/42/39/32	
	Outdoor	dB(A)	49	50	52	54	57	58	59	
Airflow	Indoor (P-Hi/Hi/Me/Lo)	m <sup>3</sup> /min	19/16/13/10	22/16/13/10	28.5/17.5/14.5/11.5	28/18/15/12	37/26/23/17	38/28/25/18	38/29/26/19	
	Outdoor	m <sup>3</sup> /min	30	32.5	34.5	30	58.4	79	75	
Exterior dimensions	Indoor (HeightxWidthxDepth)	mm	236 x 840 x 840				298 x 840 x 840			
	Outdoor (HeightxWidthxDepth)	mm	595 x 780 x 290		640 x 800 x 290		750 x 880 x 340	845 x 970 x 370	845 x 970 x 370	
Net weight	Indoor	kg	24	24	24	26	30	30	30	
	Outdoor	kg	32		37		51	67.5	68	
Refrigerant	Type		R32							
	Charge amount (Pre-charge pipe length)	kg(m)	0.83(15m)			1.05(10m)	1.55(15m)	1.70(30m)		
Piping size (Liquid/Gas)		Ømm	Ø6.35/Ø12.7				Ø6.35/Ø15.88		Ø9.52/Ø15.88	
Refrigerant line (one way) length		m	25			30	50	50	50	
Vertical height differences (Outdoor is higher/lower)		m	MAX.15/MAX.15			MAX.20/MAX.20		MAX.20/MAX.20		
Outdoor operation temperature range		°C	21-46							



# DUCT CONNECTED FDU HIGH STATIC PRESSURE FDUM MIDDLE STATIC PRESSURE

•Indoor height is thin easy to install at narrow ceiling

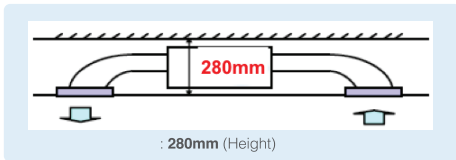

## Automatic External Static Pressure (E.S.P.) Control

Duct design was simplified. Using DC motor, the most optimum air flow volume can be achieved by this automatic control. Indoor unit will recognize external static pressure by itself automatically and keep rated air flow volume.

RC-E5  
E.S.P. button

External Static Pressure (E.S.P.) can be set by E.S.P. button.

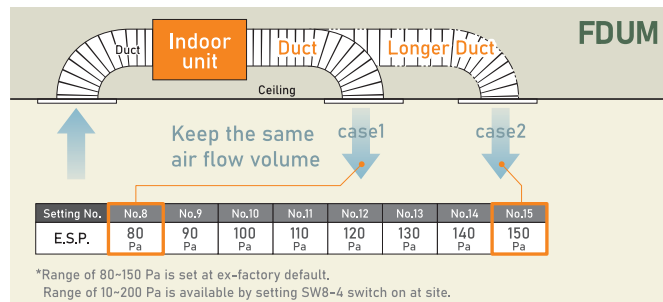
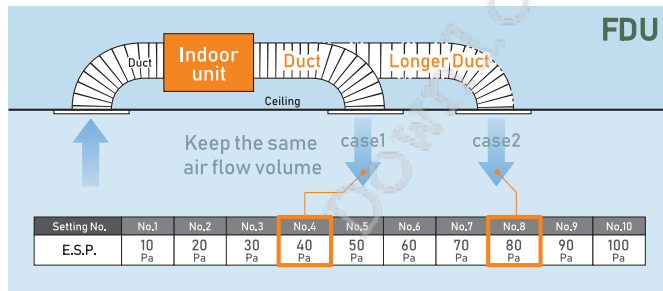

## Improvement of the Serviceability

Fan unit (impeller and motor) can be pulled out from the right side of the unit. Maintenance can be available from the right side or the bottom side.

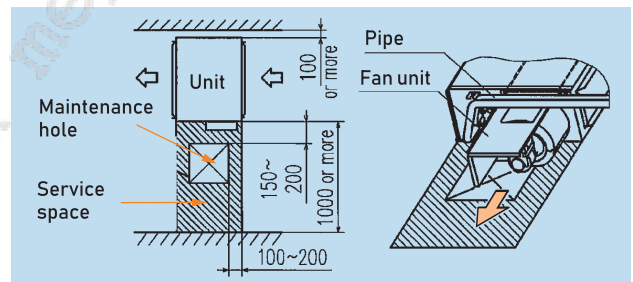

## Transparent Inspection Window

Dirt condition of the bottom of a drain pan can be checked through this transparent inspection window without removing drain pan.

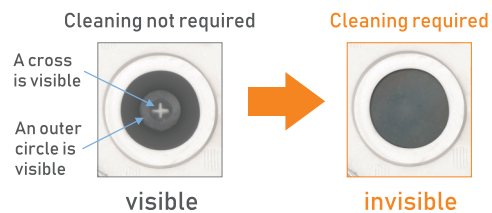

## Enhanced Installation Workability

600mm Drain Pump is mounted in all models. the indoor unit is completely hidden in the ceiling, so this is suitable for spaces with classy interior decoration.

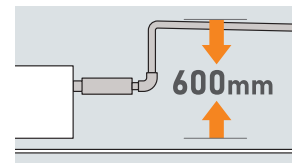

## Motion Sensor (Option)

Motion sensor is equipped in the ceiling plane or wall plane and detects the presence/absence and activity of humans in a room to improve the comfort and energy saving performance of the unit.

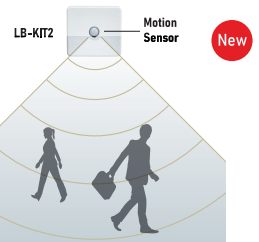

# FDUM & FDU

## INVERTER DUCT CONNECTED



FDUM40/50/60/71YA-W



FDU100/125/140YA-W

### Remote control (option)

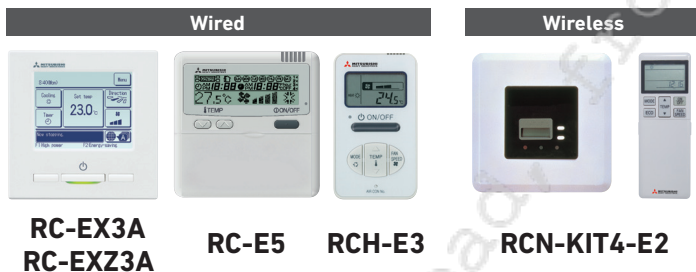

FDC40YNA-W  
FDC50YNA-W  
FDC60YNA-W



FDC100YNA-W



FDC71YNA-W



FDC125YNA-W  
FDC140YNA-W

## SPECIFICATIONS

### FDUM SERIES

### FDU SERIES

Indoor unit		FDUM40YA-W	FDUM50YA-W	FDUM60YA-W	FDUM71YA-W	FDU100YA-W	FDU125YA-W	FDU140YA-W							
Outdoor Unit		FDC40YNA-W	FDC50YNA-W	FDC60YNA-W	FDC71YNA-W	FDC100YNA-W	FDC125YNA-W	FDC140YNA-W							
Power source		1Phase 220-240V, 50Hz/ 220, 60Hz													
Normal cooling capacity (Min-Max)		kW		4.30 (1.6~4.8)	5.30 (1.6~5.7)	6.10 (1.6~6.5)	7.10 (1.3~7.7)	10.5 (2.0~11.5)	12.0(3.0~12.0)	14.0 (3.2~14.5)					
Power consumption		kW		1.13	1.59	1.77	2.20	3.10	3.82	4.50					
COP		W/W		3.81	3.33	3.45	3.23	3.39	3.14	3.11					
Max.current		A		13	13	13	13.8	17	20	27					
Sound pressure level	Indoor (P-Hi/Hi/Me/Lo)	dB(A)		32/26/25/23		33/27/26/23		38/33/29/25		39/35/33/30		39/34/30/28		42/35/31/28	
	Outdoor	dB(A)		50		52		54		57		61		59	
Airflow	Indoor (P-Hi/Hi/Me/Lo)	m <sup>3</sup> /min		13/10/9/8		20/15/13/10		24/19/15/10		36/28/25/19		39/32/26/20		48/35/28/22	
	Outdoor	m <sup>3</sup> /min		32.50		34.5		30		58.4		79		75	
Available external static pressure		Pa		STD:35/MAX:100				STD:40/MAX:200							
Exterior dimensions	Indoor (HeightxWidthxDepth)	mm		280 x 750x635		280 x950 x 635		640 x 800 x 290		750 x 880 x 340		845 x 970 x 370		845 x 970 x 370	
	Outdoor (HeightxWidthxDepth)	mm		595 x 780 x 290				640 x 800 x 290		750 x 880 x 340		845 x 970 x 370		845 x 970 x 370	
Net weight	Indoor	kg		29	29	34	34	54	54	67.5	68				
	Outdoor	kg		32		37		51		67.5		68			
Refrigerant	Type	R32													
	Charge amount (Pre-charge pipe length)	kg(m)		0.83(15m)		1.05(10m)		1.55(15m)		1.70(30m)					
Piping size (Liquid/Gas)		Ømm		Ø6.35/Ø12.7				Ø6.35/Ø15.88		Ø9.52/Ø15.88					
Refrigerant line (one way) length		m		25		30		50		50		50			
Vertical height differences (Outdoor is higher/lower)		m		MAX.15/MAX.15		MAX.20/MAX.20		MAX.20/MAX.20		MAX.20/MAX.20		MAX.50/MAX.15			
Outdoor operation temperature range		°C		21-46											



# CEILING SUSPENDED FDE

## IMPROVED INSTALLTION WORKABILITY

Increased freedom of a piping layout.  
The refrigerant pipe from the unit can be arranged in three directions, rear, right and up. The drain pipe can be arranged in two directions, left and right. This will allow a free layout of piping for various installation conditions. The unit can only be serviced from the bottom.

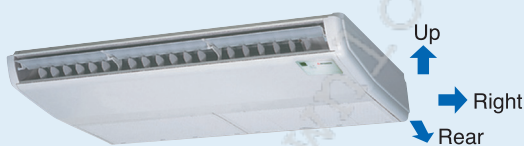

## COMPACT AND MODERN DESIGN

All models fit compactly on ceiling. (Height-210mm or 250mm). Plain, modern design featuring rounded edges gives room a comfortable atmosphere. FDE50CNVX-S weights 32kg the lightest level in the industry. Convenient and quick installation.



## Flap Control System

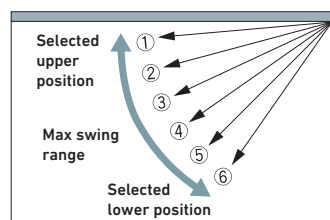

The flap can swing within the range of upper and lower flap position selected.

\* The wireless remote control is not applicable to the flap control system.

## Motion Sensor (Option)

Motion sensor is equipped in the panel and detects the presence /absence and activity of humans in a room to improve the comfort and energy saving performance of the unit.



LB-E

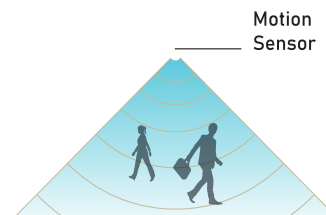

# FDE

## INVERTER CEILING SUSPENDED

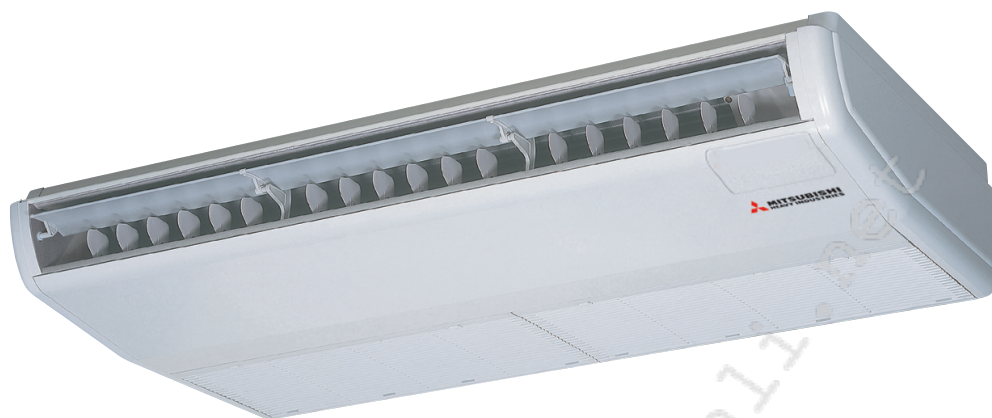

FDE40/50/60/71/100/125/140YA-W



FDC40YNA-W  
FDC50YNA-W  
FDC60YNA-W



FDC100YNA-W



FDC71YNA-W



FDC125YNA-W  
FDC140YNA-W

Remote control (option)



RC-EX3A

RC-E5

RCH-E3

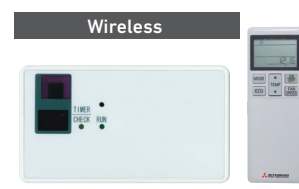

RCN-E-E3

## SPECIFICATIONS

Indoor unit		FDE40YA-W	FDE50YA-W	FDE60YA-W	FDE71YA-W	FDE100YA-W	FDE125YA-W	FDE140YA-W	
Outdoor Unit		FDC40YNA-W	FDC50YNA-W	FDC60YNA-W	FDC71YNA-W	FDC100YNA-W	FDC125YNA-W	FDC140YNA-W	
Power source		1Phase 220-240V, 50Hz/ 220, 60Hz							
Nominal cooling capacity (Min-Max)		kW	4.30 (1.6-4.8)	5.30 (1.6-5.7)	6.10 (1.6-6.5)	7.10 (1.3-7.7)	10.5 (2.0-11.5)	12.3 (3.1-12.6)	14.0 (3.2-14.5)
Power consumption		kW	1.03	1.42	1.82	2.24	2.90	3.88	4.40
COP		W/W	4.17	3.73	3.35	3.17	3.62	3.17	3.18
Max.current		A	13	13	13	13.8	17	18.0	24
Sound pressure level	Indoor (P-Hi/Hi/Me/Lo)	dB(A)	42/34/33/28		43/38/33/28	47/41/37/32	48/43/38/34	48/43/39/34	49/45/40/36
	Outdoor	dB(A)	49	50	52	54	57	62	59
Airflow	Indoor (P-Hi/Hi/Me/Lo)	m <sup>3</sup> /min	13/10/9/7		14/11/9/7	20/16/13/10	32/26/21/16.5	32/29/23/17	34/29/23/18
	Outdoor	m <sup>3</sup> /min	30	32.5	34.5	30	58.4	79	75
Exterior dimensions	Indoor (HeightxWidthxDepth)	mm	210 x 1,070 x 690			210 x 1,320 x 690	250 x 1,620 x 690		
	Outdoor (HeightxWidthxDepth)	mm	595 x 780 x 290			640 x 800 x 290	750x880x340	845x970x370	845x970x370
Net weight	Indoor	kg	28		33	43	43	43	
	Outdoor	kg	32		36	51	67.5	68	
Refrigerant	Type		R32						
	Charge amount (Pre-charge pipe length)	kg(m)	0.83(15m)			1.05(10m)	1.55(15m)	1.70(30m)	
Piping size (Liquid/Gas)		Ømm	Ø6.35/Ø12.7				Ø6.35/Ø15.88	Ø9.52/Ø15.88	
Refrigerant line (one way) length		m	25			30	50	50	50
Vertical height differences (Outdoor is higher/lower)		m	MAX.15/MAX.15			MAX.20/MAX.20		MAX.20/MAX.20	MAX.50/MAX.15
Outdoor operation temperature range		°C	21-46						

# SRK

## INVERTER WALL MOUNTED



SRK100YA-W



FDC100YNA-W



REMOTE CONTROL

Wireless (Standard)

### FUNCTIONS

#### ENERGY SAVING



#### AIR FLOW



#### CLEAN OPERATION & FILTER



#### COMFORT & CONVENIENCE



#### OTHERS



## SPECIFICATIONS

Indoor unit		SRK100YA-W	
Outdoor Unit		FDC100YNA-W	
Power source		1 Phase 220 - 240V, 50 Hz / 220V, 60Hz	
Normal cooling capacity (Min-Max)	kW	10.5 (2.0 - 11.0)	
Power consumption	kW	2.9	
COP	W/W	3.45	
Inrush current	A	13.2 / 12.6 / 11.1	
Max.current	A	17	
Sound pressure level	Indoor (P-Hi/Hi/Me/Lo)	dB(A)	47/43/38/27
	Outdoor	dB(A)	57
Airflow	Indoor (P-Hi/Hi/Me/Lo)	m <sup>3</sup> /min	24.5/21.3/17.6/10.4
	Outdoor	m <sup>3</sup> /min	58.4
Exterior dimensions	Indoor (HeightxWidthxDepth)	mm	339 x 1197 x 262
	Outdoor (HeightxWidthxDepth)	mm	750 x 880 (+88) x 340
Net weight	Indoor	kg	16.5
	Outdoor	kg	51
Refrigerant type	Type		R32
	Charge amount (Pre-charge pipe length)	kg(m)	1.55(15m)
Piping size (Liquid/Gas)	Ømm	φ6.35/φ15.88	
Refrigerant line (one way) length	m	50	
Vertical height differences (Outdoor is higher/lower)	m	MAX.20/MAX.20	
Outdoor operation temperature range	°C	21-46	

# FDT

## NON-INVERTER CEILING CASSETTE



FDT71CNZX-W  
FDT50/71/100CNZ-W  
FDT100/125/140CSZ-W

### SPECIFICATIONS

HI-COP



Draft Prevention Panel (Option)



FDC50/71CNZ-W FDC71CNZX-W FDC100CNZ-W FDC140CSZ-W  
FDT100/125CSZ-W

Indoor unit		FDT71CNZX-W	
Outdoor Unit		FDC71CNZX-W	
Power source		1 Phase 220-240V, 50Hz	
Normal cooling capacity (Min-Max)	kW	7.4	
Power consumption	kW	1.79	
EER		4.13	
Inrush current	A	39.7	
Max.current	A	11.8	
Sound pressure level	Indoor (Hi/Me/Lo)	dB(A)	43/38/37/34
	Outdoor	dB(A)	56
Airflow	Indoor (Hi/Me/Lo)	m <sup>3</sup> /min	26/21/17/15
	Outdoor	m <sup>3</sup> /min	60
Exterior dimensions	Indoor (HeightxWidthxDepth)	mm	236 x 840 x 840
	Outdoor (HeightxWidthxDepth)	mm	742 x 880(+88) x 340
Net weight	Indoor	kg	22
	Outdoor	kg	56
Refrigerant	Type		R32
	Charge amount (Pre-charge pipe length)	kg(m)	1.4(15)
Piping size (Liquid/Gas)	Ømm	Ø6.35/Ø15.88	
Refrigerant line (one way) length	m	30	
Vertical height differences (Outdoor is higher/lower)	m	Max.10/Max.10	
Outdoor operation temperature range	°C	21-46	

### SPECIFICATIONS

STANDARD

Indoor unit		FDT50CNZ-W	FDT71CNZ-W	FDT100CNZ-W	FDT100CSZ-W	FDT125CSZ-W	FDT140CSZ-W	
Outdoor Unit		FDC50CNZ-W	FDC71CNZ-W	FDC100CNZ-W	FDC100CSZ-W	FDC125CSZ-W	FDC140CSZ-W	
Power source		1 Phase,220-240,50Hz				3 Phase, 380-415, 50Hz		
Normal cooling capacity (Min-Max)	kW	5.3	7.2	10.6	10.6	12.9	14.4	
Power consumption	kW	1.41	1.98	2.98	3.09	4.22	4.70	
EER		3.76	3.64	3.56	3.43	3.06	3.06	
Inrush current	A	19.8	42.5	67.4	25.9	29.9	37	
Max.current	A	9.7	14.5	18.9	7.9	9.8	14.1	
Sound pressure level	Indoor (Hi/Me/Lo)	dB(A)	38/36/35/32	43/38/37/34	44/40/23/34	44/40/38/34	44/41/39/36	44/41/39/36
	Outdoor	dB(A)	51	55	57	56	57	58
Airflow	Indoor (Hi/Me/Lo)	m <sup>3</sup> /min	18/17/15.5/15	26/21/17/15	31/26/23/17	31/26/23/17	31/28/25/18	31/28/26/20
	Outdoor	m <sup>3</sup> /min	26.5	37	75	75	75	132
Exterior dimensions	Indoor (HeightxWidthxDepth)	mm	236 x 840 x 840	236 x 840 x 840	298 x 840 x 840	298 x 840 x 840	298 x 840 x 840	298 x 840 x 840
	Outdoor (HeightxWidthxDepth)	mm	640 x 800(+71) x 290	640 x 800(+71) x 290	845 x 970 x 370	845 x 970 x 370	845 x 970 x 370	1300 x 970 x 370
Net weight	Indoor	kg	20	22	25	25	25	
	Outdoor	kg	40.5	44	73.5	75	74	96
Refrigerant	Type		R32	R32	R32	R32	R32	
	Charge amount (Pre-charge pipe length)	kg(m)	0.91(15)	1.1(7.5)	1.7(25)	2.0(30)	1.9(25)	2.1(25)
Piping size (Liquid/Gas)	Ømm	Ø6.35/Ø15.88						
Refrigerant line (one way) length	m	30						
Vertical height differences (Outdoor is higher/lower)	m	Max.10/Max.10						
Outdoor operation temperature range	°C	21-46						

# FDT

## NON-INVERTER CEILING CASSETTE

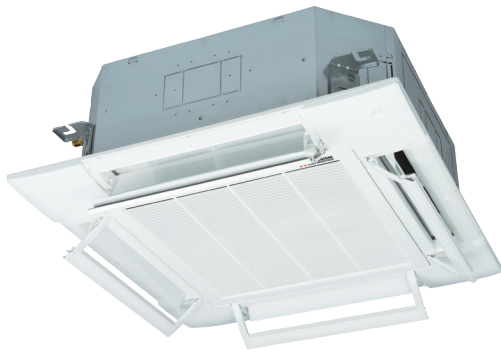

FDT50/71CNVX-S  
FDT50/71/100CNV-S  
FDT100/125/140CSV-S



Draft Prevention Panel (Option)

### REMOTE CONTROL

Wireless (option)

Wired (option)



RCN-T-5AW-E2



RC-EX3A



RC-E5



RCH-E3



FDC50/71CNV-S  
FDC50CNV-S



FDC71CNV-S



FDC100CNV-S  
FDC100/125CSV-S



FDC140CSV-S

### SPECIFICATIONS

HI-COP

Indoor unit			FDT50CNVX-S	FDT71CNVX-S
Outdoor Unit			FDC50CNVX-S	FDC71CNVX-S
Power source			1 Phase 220-240V, 50Hz	
Nominal cooling capacity (Min-Max)		kW	5.4	7.1
Power consumption		kW	1.43	1.91
COP		W/W	3.78	3.72
Max.current		A	8.2	10.7
Sound pressure level	Indoor (P-Hi/Hi/Me/Lo)	dB(A)	37/35/34/32	46/43/39/37
	Outdoor	dB(A)	51	55
Airflow	Indoor (P-Hi/Hi/Me/Lo)	m <sup>3</sup> /min	21/19/16/14	32/26/21/17
	Outdoor	m <sup>3</sup> /min	38	60
Exterior dimensions	Indoor (HeightxWidthxDepth)	mm	236 x 840 x 840	
	Outdoor (HeightxWidthxDepth)	mm	640 x 800(+71) x 290	750 x 880(+88) x 340
Net weight	Indoor	kg	27	
	Outdoor	kg	45	58
Refrigerant	Type		R410A	
	Charge amount (Pre-charge pipe length)	kg(m)	1.40(15m)	1.50(15m)
Piping size (Liquid/Gas)		Ømm	Ø6.35/Ø15.88	
Refrigerant line (one way) length		m	30	
Vertical height differences (Outdoor is higher/lower)		m	Max.10/Max.10	
Outdoor operation temperature range		°C	21-43	

### SPECIFICATIONS

STANDARD

Indoor unit			FDT50CNV-S	FDT71CNV-S	FDT100CNV-S	FDT100CSV-S	FDT125CSV-S	FDT140CSV-S
Outdoor Unit			FDC50CNV-S	FDC71CNV-S	FDC100CNV-S	FDC100CSV-S	FDC125CSV-S	FDC140CSV-S
Power source			1 Phase 220-240V, 50Hz			3 Phase 380-415, 50Hz		
Nominal cooling capacity (Min-Max)		kW	5.0	7.3	10.5	10.4	13.0	14.5
Power consumption		kW	1.55	2.25	2.91	2.88	4.16	4.50
COP		W/W	3.23	3.24	3.61	3.61	3.13	3.22
Max.current		A	8.2	13	17.3	5.8	9.6	11.0
Sound pressure level	Indoor (P-Hi/Hi/Me/Lo)	dB(A)	39/38/37/34	46/43/39/37	43/40/38/34	44/40/38/34	44/41/39/36	44/41/39/36
	Outdoor	dB(A)	51	56	55	57	58	59
Airflow	Indoor (P-Hi/Hi/Me/Lo)	m <sup>3</sup> /min	22/20/17/15	32/26/21/17	31/26/23/17	31/26/23/17	31/28/25/18	31/28/26/20
	Outdoor	m <sup>3</sup> /min	38	37	75	75	75	132
Exterior dimensions	Indoor (HeightxWidthxDepth)	mm	236 x 840 x 840			298 x 840 x 840		
	Outdoor (HeightxWidthxDepth)	mm	640 x 800(+71) x 290		845 x 970 x 370		1300x 970 x 370	
Net weight	Indoor	kg	25	27	30	30	30	30
	Outdoor	kg	42	46	77.5	79	85	108
Refrigerant	Type		R410A					
	Charge amount (Pre-charge pipe length)	kg(m)	1.00(10m)	1.40(15m)	2.4(30m)	2.65(30m)	2.15(30m)	3.10(30m)
Piping size (Liquid/Gas)		Ømm	Ø6.35/Ø15.88			Ø9.52/Ø15.88		
Refrigerant line (one way) length		m	30	30	50	50	50	50
Vertical height differences (Outdoor is higher/lower)		m	MAX.10/MAX.10			MAX.30/MAX.15		
Outdoor operation temperature range		°C	21-43					

# FDUM

## NON-INVERTER DUCT CONNECTED



FDC50/71CNZ-W



FDC100CNZ-W  
FDC100/125CSZ-W



FDC140CSZ-W



FDUM50/71/100CNZ-W  
FDUM100/125/140CSZ-W



### FILTERKIT(OPTION)

UM-FL1EF : for 50, 71  
UM-FL2EF : for 100, 125  
UM-FL3EF : for 140

External static pressure loss:5Pa

### REMOTE CONTROL

Wireless (option)

Wired (option)



RCN-KIT4-E2



RC-EX3A



RC-E5



RCH-E3

## SPECIFICATIONS

### STANDARD

Indoor unit		FDUM50CNZ-W	FDUM71CNZ-W	FDUM100CNZ-W	FDUM100CSZ-W	FDUM125CSZ-W	FDUM140CSZ-W
Outdoor Unit		FDC50CNZ-W	FDC71CNZ-W	FDC100CNZ-W	FDC100CSZ-W	FDC125CSZ-W	FDC140CSZ-W
Power source		1 Phase,220-240,50Hz			3 Phase,380-415,50Hz		
Nominal cooling capacity (Min-Max)		kW	5.3	7.0	10.6	13.0	14.9
Power consumption		kW	1.44	2.05	3.10	3.15	4.75
EER			3.68	3.41	3.42	3.37	2.93
Inrush current		A	15	42.5	58.0	29.6	20.8
Max.current		A	10.4	15.9	19.7	8.1	10.2
Sound pressure level	Indoor (Hi/Me/Lo)	dB(A)	34/30/28/26	38/33/31/29	41/36/31/29	42/36/32/29	44/37/33/29
	Outdoor	dB(A)	51	55	57	56	57
Airflow	Indoor (Hi/Me/Lo)	m <sup>3</sup> /min	14.5/11.5/10.5/9	24/19/15/10	39/32/26/20	39/32/26/20	48/35/28/22
	Outdoor	m <sup>3</sup> /min	26.5	37	75	75	132
Exterior dimensions	Indoor (HeightxWidthxDepth)	mm	280 x 750 x 635	280 x 950 x 635	280 x 1370 x 740	280 x 1370 x 740	280 x 1370 x 740
	Outdoor (HeightxWidthxDepth)	mm	640 x 800(+71) x 290	640 x 800(+71) x 290	845 x 970 x 370	845 x 970 x 370	845 x 970 x 370
Net weight	Indoor	kg	29	34	53	53	53
	Outdoor	kg	40.5	44	73.5	75	96
Refrigerant	Type		R32	R32	R32	R32	R32
	Charge amount (Pre-charge pipe length)	kg(m)	0.91(15)	1.1(7.5)	1.7(25)	2.0(30)	1.9(25)
Piping size (Liquid/Gas)		Ømm	Ø6.35/Ø15.88	Ø6.35/Ø15.88	Ø9.52/Ø15.88	Ø9.52/Ø15.88	Ø9.52/Ø15.88
Refrigerant line (one way) length		m	30	25	50	50	50
Vertical height differences (Outdoor is higher/lower)		m	Max.10/Max.10	Max.10/Max.10	Max.30/Max.15	Max.30/Max.15	Max.30/Max.15
Outdoor operation temperature range		°C	21-46	21-46	21-46	21-46	21-46

# FDUM

## NON-INVERTER DUCT CONNECTED



FDC50/71CNV-S



FDC100CNV-S  
FDC100/125CSV-S



FDC140CSV-S



FDUM50/71/100CNV-S  
FDUM100/125/140CSV-S

### FILTERKIT(OPTION)

UM-FL1EF : for 50, 71  
UM-FL2EF : for 100, 125  
UM-FL3EF : for 140



External static pressure loss:5Pa

### REMOTE CONTROL

Wireless (option)

Wired (option)



RCN-KIT4-E2



RC-EX3A



RC-E5



RCH-E3

## SPECIFICATIONS

### STANDARD

Indoor unit		FDUM50CNV-S	FDUM71CNV-S	FDUM100CNV-S	FDUM100CSV-S	FDUM125CSV-S	FDUM140CSV-S
Outdoor Unit		FDC50CNV-S	FDC71CNV-S	FDC100CNV-S	FDC100CSV-S	FDC125CSV-S	FDC140CSV-S
Power source		1 Phase 220-240V, 50Hz			3 Phase 380-415, 50Hz		
Normal cooling capacity (Min-Max)		kW		5.0	7.1	10.5	10.4
Power consumption		kW		1.613	2.29	3.03	3.10
COP		W/W		3.10	3.10	3.47	3.35
Max.current		A		8.2	13	18.3	6.2
Sound pressure level	Indoor (P-Hi/Hi/Me/Lo)	dB(A)		35/31/29/27	38/33/31/29	42/36/32/29	42/36/32/29
	Outdoor	dB(A)		51	56	55	57
Airflow	Indoor (P-Hi/Hi/Me/Lo)	m <sup>3</sup> /min		13/10/9/8	24/19/15/10	39/32/26/20	39/32/26/20
	Outdoor	m <sup>3</sup> /min		38	37	75	75
Available external static pressure		Pa		STD:35/MAX:100		STD:60/MAX:100	
Exterior dimensions	Indoor (HeightxWidthxDepth)	mm		280 x 750 x 635	280 x 950 x 635	280 x 1,370 x 740	
	Outdoor (HeightxWidthxDepth)	mm		640 x 800(+71) x 290		845 x 970 x 370	
Net weight	Indoor	kg		29	34	53	53
	Outdoor	kg		42	46	77.5	79
Refrigerant	Type	R410A					
	Charge amount (Pre-charge pipe length)	kg(m)		1.00(15m)	1.40(15m)	2.4(30m)	2.65(30m)
Piping size (Liquid/Gas)		Ømm		Ø6.35/Ø15.88		Ø9.52/Ø15.88	
Refrigerant line (one way) length		m		30	30	50	50
Vertical height differences (Outdoor is higher/lower)		m		MAX.10/MAX.10		MAX.30/MAX.15	
Outdoor operation temperature range		°C		21-43			

# FDE

## NON-INVERTER CEILING SUSPENDED



FDC50CNZX-W

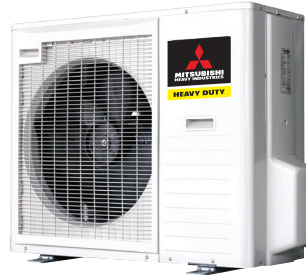

FDC71CNZX-W

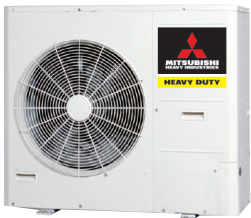

FDC100CNZX-W  
FDC100/125CSZ-W



FDE50/71CNVX-W  
FDE100CNZ-W  
FDE100/125/140CSZ-W



FDC140CSZ-W

### REMOTE CONTROL

Wireless (Standard)

Wired (option)



RC-EX3A

RC-E5

RCH-E3

## SPECIFICATIONS

HI COP

STANDARD

Indoor unit		FDE50CNZX-W	FDE71CNZX-W	FDE100CNZ-W	FDE100CSZ-W	FDE125CSZ-W	FDE140CSZ-W
Outdoor Unit		FDC50CNZX-W	FDC71CNZX-W	FDC100CNZ-W	FDC100CSZ-W	FDC125CSZ-W	FDC140CSZ-W
Power source		1 Phase 220-240V, 50Hz		1 Phase 220-240V, 50Hz	3 Phase, 380-415, 50Hz		
Nominal cooling capacity (Min-Max)		kW	5.5	7.4	10.6	12.9	14.4
Power consumption		kW	1.42	1.79	2.98	3.10	4.70
EER			3.87	4.13	3.56	3.42	3.06
Inrush current		A	19.6	38.3	58.8	21.2	28.8
Max.current		A	9.9	12.0	19.4	7.9	10.0
Sound pressure level	Indoor (Hi/Me/Lo)	dB(A)	44/39/34	48/42/35	48/41/34	47/41/34	48/43/34
	Outdoor	dB(A)	50	56	57	56	57
Airflow	Indoor (Hi/Me/Lo)	m <sup>3</sup> /min	19/15.5/12	23/18/13	35/26/17	35/26/17	35/29/18
	Outdoor	m <sup>3</sup> /min	26.5	60	75	75	75
Exterior dimensions	Indoor (HeightxWidthxDepth)	mm	210 x 1320 x 690	210 x 1320 x 690	250 x 1620 x 690	250 x 1620 x 690	250 x 1620 x 690
	Outdoor (HeightxWidthxDepth)	mm	640 x 800(+71) x 290	742 x 880(+88) x 340	845 x 970 x 370	845 x 970 x 370	845 x 970 x 370
Net weight	Indoor	kg	32	32	42	42	42
	Outdoor	kg	40.5	56	73.5	75	96
Refrigerant	Type		R32	R32	R32	R32	R32
	Charge amount (Pre-charge pipe length)	kg(m)	1.0(20)	1.4(15)	1.7(25)	2.0(30)	1.9(25)
Piping size (Liquid/Gas)		Ømm	Ø6.35/Ø15.88	Ø6.35/Ø15.88	Ø9.52/Ø15.88	Ø9.52/Ø15.88	Ø9.52/Ø15.88
Refrigerant line (one way) length		m	30	30	50	50	50
Vertical height differences (Outdoor is higher/lower)		m	Max.10/Max.10	Max.10/Max.10	Max.30/Max.15	Max.30/Max.15	Max.30/Max.15
Outdoor operation temperature range		°C	21-46	21-46	21-46	21-46	21-46

# FDE

## NON-INVERTER CEILING SUSPENDED



FDC50CNVX-S

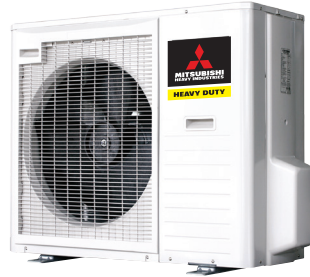

FDC71CNVX-S

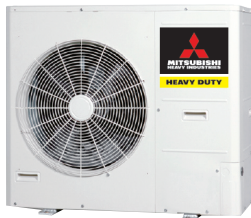

FDC100CNV-S  
FDC100/125CSV-S



FDE50/71CNVX-S  
FDE100CNV-S  
FDE100/125/140CSV-S



FDC140CSV-S

### REMOTE CONTROL

Wireless (Standard)

Wired (option)



RC-EX3A

RC-E5

RCH-E3

## SPECIFICATIONS

HI COP

STANDARD

Indoor unit		FDE50CNVX-S	FDE71CNVX-S	FDE100CNV-S	FDE100CSV-S	FDE125CSV-S	FDE140CSV-S	
Outdoor Unit		FDC50CNVX-S	FDC71CNVX-S	FDC100CNV-S	FDC100CSV-S	FDC125CSV-S	FDC140CSV-S	
Power source		1 Phase 220-240V, 50Hz			3 Phase 380-415, 50Hz			
Norminal cooling capacity (Min-Max)		kW	5.4	7.1	10.5	10.4	12.5	14.5
Power consumption		kW	1.44	1.91	2.91	2.88	4.16	4.50
COP		W/W	3.75	3.72	3.61	3.61	3.00	3.22
Max.current		A	8.2	10.7	17.5	6.0	9.7	11.0
Sound pressure level	Indoor (Hi/Me/Lo)	dB(A)	43/39/34	48/42/35	47/41/34	47/41/34	47/43/34	48/43/35
	Outdoor	dB(A)	51	55	55	57	58	59
Airflow	Indoor (Hi/Me/Lo)	m <sup>3</sup> /min	20/16.5/13	23/18/13	35/26/17	35/26/17	35/29/18	35/29/18
	Outdoor	m <sup>3</sup> /min	38	60	75	75	75	132
Exterior dimensions	Indoor (HeightxWidthxDepth)	mm	210 x 1,320 x 690			250 x 1,620 x 690		
	Outdoor (HeightxWidthxDepth)	mm	640 x 800(+71) x 290	750 x 880(+88) x 340	845 x 970 x 370			1300 x 970 x 370
Net weight	Indoor	kg	32	32	42	42	42	42
	Outdoor	kg	45	58	77.5	79	85	108
Refrigerant	Type	R410A						
	Charge amount (Pre-charge pipe length)	kg(m)	1.40(15m)	1.50(15m)	2.40(30m)	2.65(30m)	2.15(30m)	3.10(30m)
Piping size (Liquid/Gas)		Ømm	Ø6.35/Ø15.88		Ø9.52/Ø15.88	Ø9.52/Ø15.88		
Refrigerant line (one way) length		m	30	30	50	50	50	50
Vertical height differences (Outdoor is higher/lower)		m	MAX.10/MAX.10			MAX.30/MAX.15		
Outdoor operation temperature range		°C	21-43					

# FDF

## NON-INVERTER FLOOR STANDING



FDC71CNV-S

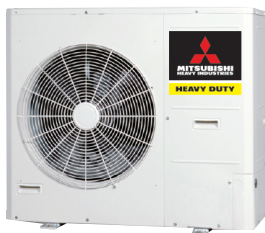

FDC125CSV-S



FDC140CSV-S



FDF71CNV-S  
FDF125/140CSV-S

REMOTE CONTROL

Wireless (standard)



### SPECIFICATIONS

#### STANDARD

Indoor unit		FDF71CNV-S	FDF125CSV-S	FDF140CSV-S	
Outdoor Unit		FDC71CNV-S	FDC125CSV-S	FDC140CSV-S	
Power source		1 Phase 220-240V, 50Hz	3 Phase 380-415V, 50Hz		
Nominal cooling capacity (Min-Max)		kW	7.1	12.5	14
Power consumption		kW	2.5	4.46	4.7
COP		W/W	2.84	2.8	2.98
Max.current		A	13	10.5	11.4
Sound pressure level	Indoor (Hi/Me/Lo)	dB(A)	48/40*	51/41/37	54/41/37
	Outdoor	dB(A)	56	58	59
Airflow	Indoor (Hi/Me/Lo)	m <sup>3</sup> /min	21/15**	25/17/15	28/17/15
	Outdoor	m <sup>3</sup> /min	37	75	132
Exterior dimensions	Indoor (HeightxWidthxDepth)	mm	1,850 x 600 x 320		
	Outdoor (HeightxWidthxDepth)	mm	640 x 800(+71) x 290	845 x 970 x 370	1,300 x 970 x 370
Net weight	Indoor	kg	51	53	53
	Outdoor	kg	46	85	108
Refrigerant	Type		R410A		
	Charge amount (Pre-charge pipe length)	kg(m)	1.40 (15m)	2.15 (30m)	3.10 (30m)
Piping size (Liquid/Gas)		Ømm	Ø6.35 / Ø15.88	Ø9.52 / Ø15.88	
Refrigerant line (one way) length		m	30	50	50
Vertical height differences (Outdoor is higher/lower)		m	MAX.10/MAX.10	MAX.30/MAX.15	
Outdoor operation temperature range		°C	21-43		

\*Sound pressure level (Hi/Lo)

\*\*Airflow (Hi/Lo)

# FDU

## BIG CAPACITY DUCT CONNECTED



FDU200/250CSY-S



FDU400/500CSY-S



FDC200/250CSY-S

**REMOTE CONTROL**

Wired (standard)    Wireless (option)



RCN-Q1

### SPECIFICATIONS

Indoor unit		FDU200CSY-S	FDU250CSY-S	FDU400CSY-S	FDU500CSY-S
Outdoor Unit		FDC200CSY-S	FDC250CSY-S	FDC200CSY-S x2	FDC250CSY-S x2
Power source	Indoor	1 Phase 220 - 240V, 50 Hz			
	Outdoor	3 Phase 380 - 415V, 50 Hz			
Nominal cooling capacity	kW	22.5	25.0	42.0	50.0
Power consumption	kW	7.3	9.0	14.6	18.0
COP	W/W	3.08	2.78	2.87	2.78
Max.current	dB(A)	19.0	20.0	38.0	40.0
Sound pressure level	Indoor (Hi/Me/Lo)	dB(A)	54/51/48	54/51/48	58/55/52
	Outdoor	dB(A)	60		60x2
Airflow	Indoor (Hi/Me/Lo)	m <sup>3</sup> /min	76/67/55	76/67/55	120/113/93
	Outdoor	m <sup>3</sup> /min	200		200x2
Available static pressure	Pa	STD: 80 MAX: 200			
Exterior dimensions	Indoor (HeightxWidthxDepth)	mm	360x1570x830		685 x 1570 x 830
	Outdoor (HeightxWidthxDepth)	mm	1675x1080x480		(1675 x 1080 x 480) x 2
Net weight	Indoor	kg	99	99	180
	Outdoor	kg	181	181	181x2
Refrigerant	Type		R410		
	Charge amount (Pre-charge pipe length)	kg(m)	6.5(5m)	7.4(5m)	6.5(5m) x 2
Piping size (Liquid/Gas)	φmm	φ12.7/φ22.22			
Refrigerant line (one way) length	m	50			
Vertical height differences (Outdoor is higher/lower)	m	MAX.30/MAX.15			
Outdoor operation temperature range	°C	10-43			

# FDF

## BIG CAPACITY FLOOR STANDING



FDF250CSY-S



FDAS500CSY-S

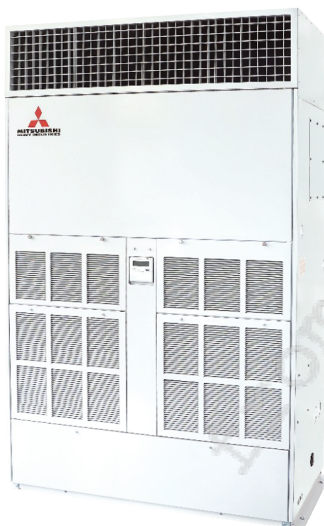

FDF500CSY-S +  
AS-DA500CSY



### SPECIFICATIONS

Indoor unit		FDF250CSY-S	FDF500CSY-S + AS-DA500CSY	FDAS500CSY-S
Outdoor Unit		FDC250CSY-S	FDC250CSY-S x 2	
Power source	Indoor	1 Phase 220 - 240V, 50 Hz	3 Phase 380 - 415V, 50 Hz	
	Outdoor		3 Phase 380 - 415V, 50 Hz	
Nominal cooling capacity	kW	25.0	50.0	
Power consumption	kW	9.0	18.0	19.0
COP		2.78	2.78	2.63
Max.current	dB(A)	20.0	41.0	43.0
Sound pressure level	Indoor (Hi/Me/Lo)	dB(A)	54/49/44	68
	Outdoor	dB(A)	60	60x2
Airflow	Indoor (Hi/Me/Lo)	m <sup>3</sup> /min	60/41/35	160
	Outdoor	m <sup>3</sup> /min	200	200x2
Exterior dimensions	Indoor (HeightxWidthxDepth)	mm	1850 x 1200 x 320	2020 x 1500 x 800
	Outdoor (HeightxWidthxDepth)	mm	1675 x 1080 x 480	(1675 x 1080 x 480) x 2
Net weight	Indoor	kg	99	362
	Outdoor	kg	181	181x2
Refrigerant	Type		R410A	
	Charge amount (Pre-charge pipe length)	kg(m)	7.4(5m)	7.4(5m) x 2
Piping size (Liquid/Gas)	φmm	φ12.7/φ22.22		
Refrigerant line (one way) length	m	50		
Vertical height differences (Outdoor is higher/lower)	m	MAX.30/MAX.15		
Outdoor operation temperature range	°C	10-43		

# Usage Limitation

## Inverter

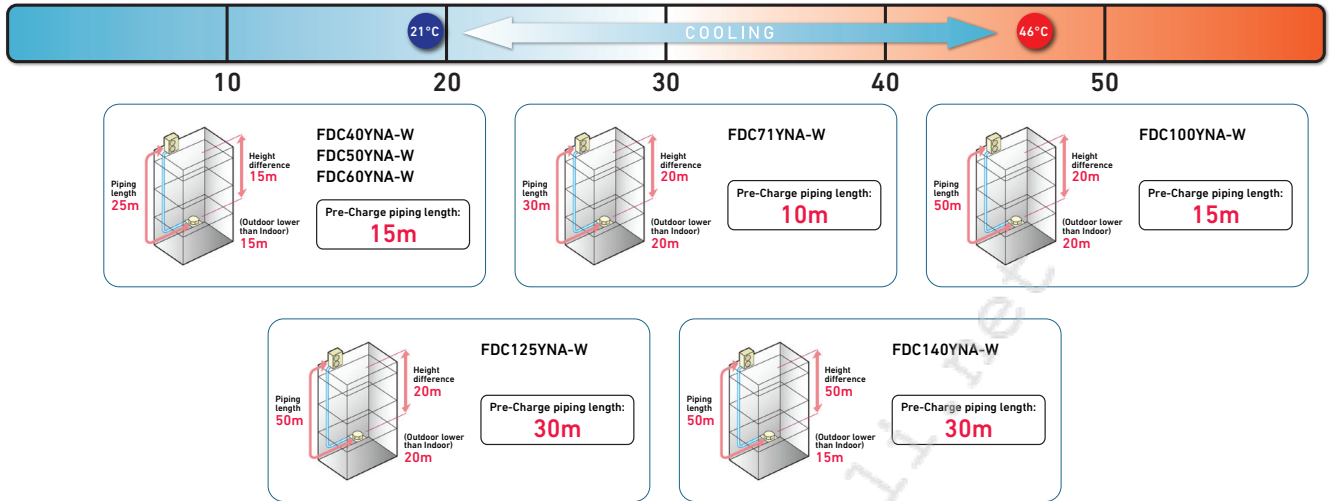

## Non-Inverter

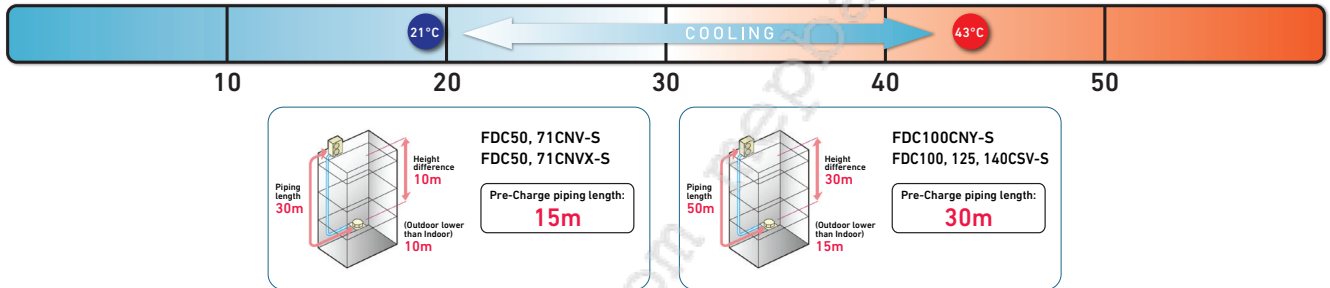

## Non-Inverter

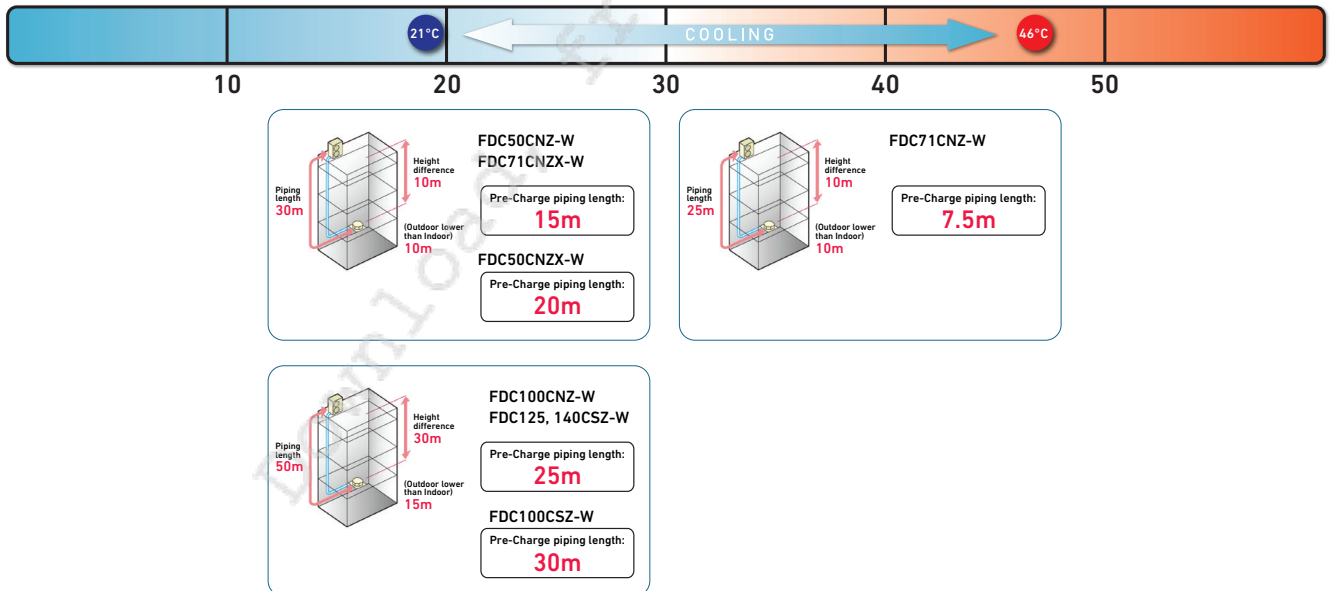

## Big Capacity

